

## Hook clamps

Steel or stainless steel

### STANDARD EXECUTIONS

- **TLAL.Z**: lever body and bracket in zinc-plated steel.
- **TLAL.SST**: lever body and bracket in AISI 304 stainless steel.

### SPECIAL EXECUTIONS ON REQUEST

- Hook clamps in unplated steel.
- Catch brackets in different shapes and finishes.

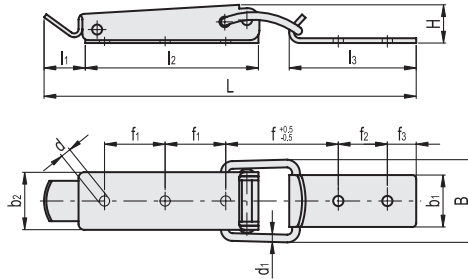

### TLAL.Z

Code	Description	b <sub>2</sub>	L	B	H	d	d <sub>1</sub>	d <sub>2</sub>	b <sub>1</sub>	l <sub>1</sub>	l <sub>2</sub>	l <sub>3</sub>	l <sub>4</sub>	f	f <sub>1</sub>	f <sub>2</sub>	f <sub>3</sub>	h <sub>1</sub>	h <sub>2</sub>	Max. working load [N]	Load at breakage [N]	⚖️
420085	TLAL.Z-16.4/102+R	16.4	102	23	11	3.2	2	4	13	16	44	30	34.5	34.5	12.5	12	5	11.5	15.5	550	1200	32
420063	TLAL.Z-23/140.5+R	23	140.5	34	12.5	4.1	3	7	19	16	70	43	55	38	22.5	20	8	13	20	1500	3000	79
420053	TLAL.Z-30/193.5+R	30	193.5	43	19	5.3	4	11	27	21.5	90	66	71	58.5	31.5	25.5	15	20.5	30.5	2000	4000	189

### TLAL.SST

STAINLESS STEEL

Code	Description	b <sub>2</sub>	L	B	H	d	d <sub>1</sub>	d <sub>2</sub>	b <sub>1</sub>	l <sub>1</sub>	l <sub>2</sub>	l <sub>3</sub>	l <sub>4</sub>	f	f <sub>1</sub>	f <sub>2</sub>	f <sub>3</sub>	h <sub>1</sub>	h <sub>2</sub>	Max. working load [N]	Load at breakage [N]	⚖️
420086	TLAL.SST-16.4/102+R	16.4	102	23	11	3.2	2	4	13	16	44	30	34.5	34.5	12.5	12	5	11.5	15.5	550	1200	32
420064	TLAL.SST-23/140.5+R	23	140.5	34	12.5	4.1	3	7	19	16	70	43	55	38	22.5	20	8	13	20	1500	3000	79
420054	TLAL.SST-30/193.5+R	30	193.5	43	19	5.3	4	11	27	21.5	90	66	71	58.5	31.5	25.5	15	20.5	30.5	2000	4000	189