

## Rubber buffers

### Rubber and steel or stainless steel

#### STANDARD EXECUTIONS

- **DVB.7:** bushing with threaded blind hole and base plate in polished zinc-plated steel, vibration-damper body in natural rubber NR, black colour, hardness 40, 55, 70 Shore A  $\pm 5$ .
- **DVB.7-SST:** bushing with threaded blind hole and base plate in AISI 304 stainless steel, vibration-damper body in natural rubber NR, black colour, hardness 55 Shore A  $\pm 5$ .

#### FEATURES AND APPLICATIONS

DVB. rubber buffers have been designed to damp vibrations, shocks and noises produced by moving bodies or non-balanced vibrating masses of equipment and machines.

DVB elements are generally used as a bumper or as a limit stop for the absorption of vibrations.

Vibrations can cause:

- malfunctioning and reduction of the machine lifespan and/or of the adjacent ones;
- damage to operator's health;
- noise.

Load diagrams for each single code are available on request.

See Technical data and guidelines for the choice(on page ).

#### SPECIAL EXECUTIONS ON REQUEST

Natural rubber NR, hardness 40, 70 Shore A  $\pm 5$  for the executions with AISI 304 stainless steel base.





DVB.7

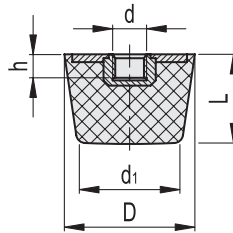

DVB.7 - 20 - 17 - M5 - 55  
 D L d Shore A

| Description       | D  | L  | d   | d <sub>1</sub> | h  | △  | Hardness 40 Shore A |              |                     | Hardness 55 Shore A |        |              | Hardness 70 Shore A |                  |        |              |                     |                  |
|-------------------|----|----|-----|----------------|----|----|---------------------|--------------|---------------------|---------------------|--------|--------------|---------------------|------------------|--------|--------------|---------------------|------------------|
|                   |    |    |     |                |    |    | Code                | Max load [N] | Max deflection [mm] | Stiffness [N/mm]    | Code   | Max load [N] | Max deflection [mm] | Stiffness [N/mm] | Code   | Max load [N] | Max deflection [mm] | Stiffness [N/mm] |
| DVB.7-20-17-M5-*  | 20 | 17 | M5  | 10             | 5  | 12 | 432301              | 207          | 4,25                | 49                  | 432101 | 253          | 4,25                | 60               | 432501 | 311          | 4,25                | 73               |
| DVB.7-20-17-M6-*  | 20 | 17 | M6  | 10             | 6  | 18 | 432302              | 207          | 4,25                | 49                  | 432102 | 253          | 4,25                | 60               | 432502 | 311          | 4,25                | 73               |
| DVB.7-25-17-M6-*  | 25 | 17 | M6  | 19             | 6  | 22 | 432303              | 289          | 4,25                | 68                  | 432103 | 358          | 4,25                | 84               | 432503 | 454          | 4,25                | 107              |
| DVB.7-32-22-M8-*  | 32 | 22 | M8  | 24             | 8  | 33 | 432311              | 411          | 5,5                 | 75                  | 432111 | 506          | 5,5                 | 92               | 432511 | 673          | 5,5                 | 122              |
| DVB.7-38-35-M8-*  | 38 | 35 | M8  | 30             | 8  | 46 | 432321              | 604          | 8,75                | 69                  | 432121 | 893          | 8,75                | 102              | 432521 | 1104         | 8,75                | 126              |
| DVB.7-38-35-M10-* | 38 | 35 | M10 | 30             | 10 | 56 | 432331              | 604          | 8,75                | 69                  | 432131 | 893          | 8,75                | 102              | 432531 | 1104         | 8,75                | 126              |
| DVB.7-43-50-M10-* | 43 | 50 | M10 | 30             | 10 | 72 | 432341              | 1327         | 12,5                | 106                 | 432141 | 2011         | 12,5                | 161              | 432541 | 3027         | 12,5                | 242              |
| DVB.7-50-20-M10-* | 50 | 20 | M10 | 40             | 10 | 61 | 432351              | 2763         | 5                   | 553                 | 432151 | 3570         | 5                   | 714              | 432551 | 4875         | 5                   | 975              |
| DVB.7-60-40-M10-* | 60 | 40 | M10 | 40             | 10 | 93 | 432361              | 1685         | 10                  | 169                 | 432161 | 2101         | 10                  | 210              | 432561 | 3231         | 10                  | 323              |

DVB.7-SST

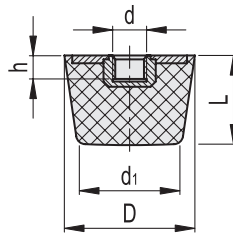

DVB.7 - 20 - 17 - SST - M5 - 55  
 D L Stainless steel d Shore A

| Description            | D  | L  | d   | d <sub>1</sub> | h  | △  | Hardness 40 Shore A |              |                     | Hardness 55 Shore A |        |              | Hardness 70 Shore A |                  |            |              |                     |                  |
|------------------------|----|----|-----|----------------|----|----|---------------------|--------------|---------------------|---------------------|--------|--------------|---------------------|------------------|------------|--------------|---------------------|------------------|
|                        |    |    |     |                |    |    | Code                | Max load [N] | Max deflection [mm] | Stiffness [N/mm]    | Code   | Max load [N] | Max deflection [mm] | Stiffness [N/mm] | Code       | Max load [N] | Max deflection [mm] | Stiffness [N/mm] |
| DVB.7-20-17-SST-M5-55  | 20 | 17 | M5  | 10             | 5  | 12 | ON REQUEST          | 207          | 4,25                | 49                  | 432701 | 253          | 4,25                | 60               | ON REQUEST | 311          | 4,25                | 73               |
| DVB.7-20-17-SST-M6-55  | 20 | 17 | M6  | 10             | 6  | 18 |                     | 207          | 4,25                | 49                  | 432702 | 253          | 4,25                | 60               |            | 311          | 4,25                | 73               |
| DVB.7-25-17-SST-M6-55  | 25 | 17 | M6  | 19             | 6  | 22 |                     | 289          | 4,25                | 68                  | 432703 | 358          | 4,25                | 84               |            | 454          | 4,25                | 107              |
| DVB.7-32-22-SST-M8-55  | 32 | 22 | M8  | 24             | 8  | 33 |                     | 411          | 5,5                 | 75                  | 432711 | 506          | 5,5                 | 92               |            | 673          | 5,5                 | 122              |
| DVB.7-38-35-SST-M8-55  | 38 | 35 | M8  | 30             | 8  | 46 |                     | 604          | 8,75                | 69                  | 432721 | 893          | 8,75                | 102              |            | 1104         | 8,75                | 126              |
| DVB.7-38-35-SST-M10-55 | 38 | 35 | M10 | 30             | 10 | 56 |                     | 604          | 8,75                | 69                  | 432731 | 893          | 8,75                | 102              |            | 1104         | 8,75                | 126              |
| DVB.7-43-50-SST-M10-55 | 43 | 50 | M10 | 30             | 10 | 72 |                     | 1327         | 12,5                | 106                 | 432741 | 2011         | 12,5                | 161              |            | 3027         | 12,5                | 242              |
| DVB.7-50-20-SST-M10-55 | 50 | 20 | M10 | 40             | 10 | 61 |                     | 2763         | 5                   | 553                 | 432751 | 3570         | 5                   | 714              |            | 4875         | 5                   | 975              |
| DVB.7-60-40-SST-M10-55 | 60 | 40 | M10 | 40             | 10 | 93 |                     | 1685         | 10                  | 169                 | 432761 | 2101         | 10                  | 210              |            | 3231         | 10                  | 323              |