

Anti-rotation vacuum cups spring suspensions

Threaded connection male, steel, aluminium and brass

MATERIAL

Brass or nickel-plated brass stem.
Stainless steel spring.
Zinc-plated steel or brass threaded sleeve.
Quick fitting in blue anodised aluminium.

STANDARD EXECUTIONS

- **VPC-M**: with male straight threaded connection.
- **VPC-M-L**: with male L-shaped threaded connection.

FEATURES AND APPLICATIONS

VPC vacuum cup suspensions comprise:

- a brass stem with a hexagonal section for fixing the vacuum cup. This conformation prevents the shank and the vacuum cup fixed on it from rotating on its axis;
- a steel or brass threaded sleeve, equipped with two tightening ring nuts, for quick assembly of the vacuum cup suspension to the automation device;
- a spring to cushion the impact of the vacuum cup and at the same time maintain a constant pressure with the load to be lifted;
- a quick fitting for connection to the suction hose.

Suitable for vacuum cups with a minimum diameter of 45 mm and a maximum of 110 mm.

The effective spring stroke is functional to the length (l3) of the stem, in particular:

- 16 mm for a length of 28 mm
- 49 mm for a length of 65 mm
- 74 mm for a length of 95 mm

Compatible with 6x8 diameter plastic hose.

See Technical Data for vacuum cups (on page -).

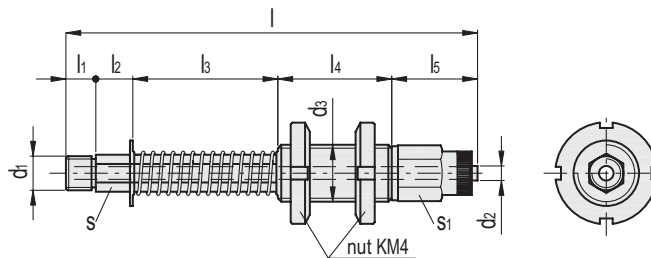

VPC-M

Code	Description	d1	d2*	d3	l	l1	l2	l3	l4	l5	s	s1	⚖
VV.41002	VPC-55-90-G1/4-M	G1/4	6	M25x1.5	144	15	-	55	40	34	22	16	314
VV.41003	VPC-55-91-G3/8-M	G3/8	6	M25x1.5	144	15	-	55	40	34	22	16	320
VV.41005	VPC-55-92-G3/8-M	G3/8	9	M25x1.5	150	15	-	55	40	40	22	16	330
VV.41101	VPC-95-28-M12-M	M12	6	M20x1	125	10	15	28	40	32	13	17	180
VV.41105	VPC-95-65-M12-M	M12	6	M20x1	162	10	15	65	40	32	13	17	225
VV.41110	VPC-95-95-M12-M	M12	6	M20x1	192	10	15	95	40	32	13	17	246
VV.41102	VPC-95-28-G1/4-M	G1/4	6	M20x1	125	10	15	28	40	32	13	17	181
VV.41106	VPC-95-65-G1/4-M	G1/4	6	M20x1	162	10	15	65	40	32	13	17	226
VV.41111	VPC-95-95-G1/4-M	G1/4	6	M20x1	192	10	15	95	40	32	13	17	247

* Compatible with compressed air tubes of the diameter in the table.

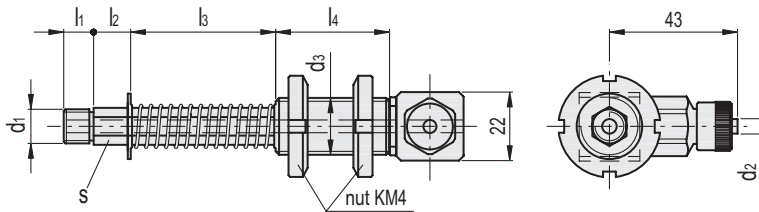

VPC-M-L

Code	Description	d1	d2*	d3	l1	l2	l3	l4	s	
VV.41001	VPC-55-90-G1/4-M-L	G1/4	6	M25x1.5	15	-	55	40	22	329
VV.41004	VPC-55-91-G3/8-M-L	G3/8	6	M25x1.5	15	-	55	40	22	335
VV.41006	VPC-55-92-G3/8-M-L	G3/8	9	M25x1.5	15	-	55	40	22	345
VV.41103	VPC-95-28-G1/4-M-L	G1/4	6	M20x1	10	15	28	40	13	195
VV.41107	VPC-95-65-G1/4-M-L	G1/4	6	M20x1	10	15	65	40	13	240
VV.41109	VPC-95-95-M12-M-L	M12	6	M20x1	10	15	95	40	13	261
VV.41104	VPC-95-28-M12-M-L	M12	6	M20x1	10	15	28	40	13	196
VV.41108	VPC-95-65-M12-M-L	M12	6	M20x1	10	15	65	40	13	241
VV.41112	VPC-95-95-G1/4-M-L	G1/4	6	M20x1	10	15	95	40	13	262

* Compatible with compressed air tubes of the diameter in the table.